



RGC-SERIES

DURA-SLIDE RGC Series of Non-Powered Linear Slides provide a time proven design that is extremely reliable, yet economical. The RGC Series has been tested under actual operating conditions with up to 160 million inches accumulated travel with negligible wear.

FEATURES

DURA-SLIDE RGC Series maintains all rod bores parallel to the mounting surface within .002" per foot. The slide bearings are oil impregnated bronze bushings, permanently protected by neoprene seals, eliminating the need for re-lubrication. Bronze bushings are utilized as standard, rather than linear ball bearings, because bushings distribute the load over a larger surface area. This results in less wear on the slide rods. Optional Linear ball bearings are available for low sliding friction applications. Both rods are pinned to the end blocks to assure positive location.

MOUNTING STYLES

DURA-SLIDE RGC Series can be mounted in any plane, provided both end blocks are set on machined surfaces to prevent distortion. Either the main body or the end blocks function as the fixed supports. An offset end block option permits mounting both end blocks to a plane surface without risers. Tapped holes in the main body and special strokes are available options to further increase the adaptability of the RGC series.

- 5 Basic Sizes
- Standard Strokes

Use the RGC Series of Non-powered Linear Slides wherever you need durable and precise guided linear motion.

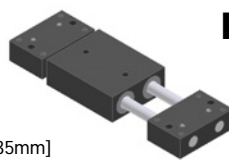

RGC-5

ROD DIA.

- Inch : 1/4"
- Metric : [6.35mm]

See Page **4-2.3**

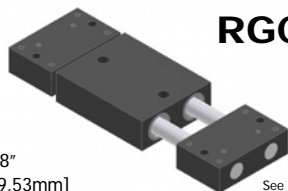

RGC-10

ROD DIA.

- Inch : 3/8"
- Metric : [9.53mm]

See Page **4-2.4**

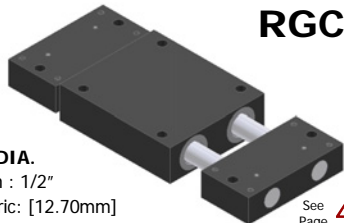

RGC-20

ROD DIA.

- Inch : 1/2"
- Metric : [12.70mm]

See Page **4-2.5**

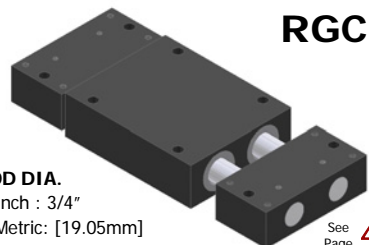

RGC-30

ROD DIA.

- Inch : 3/4"
- Metric : [19.05mm]

See Page **4-2.6**

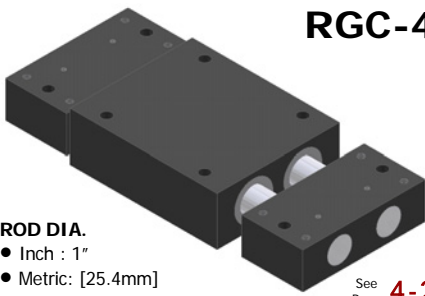

RGC-40

ROD DIA.

- Inch : 1"
- Metric : [25.4mm]

See Page **4-2.7**

TECHNICAL SPECIFICATION

	ENGLISH	METRIC
Construction		
Stroke Range	1/4" - 10"	6.3mm - 254mm
Rod Diameter Range	1/4" - 1"	6.35mm - 25.4mm
Rod Seals	Neoprene	
Block Material	Aluminum - Black anodize	
Temperature Range		
Neoprene Seals	-30 to 180 F	-35 to 80 C

OPERATING PRINCIPLES

Provides precision guided linear motion

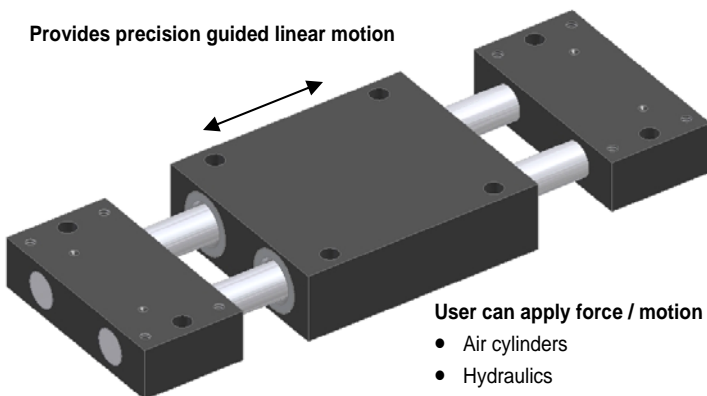

User can apply force / motion with :

- Air cylinders
- Hydraulics
- Mechanical Linkages

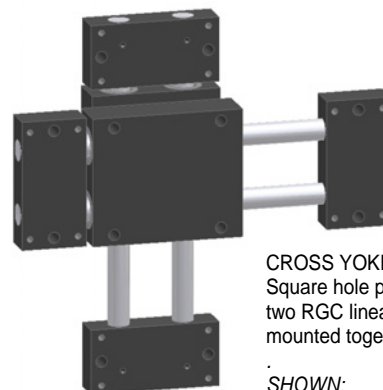

CROSS YOKE

Square hole pattern in the Main body allows two RGC linear slides of the same model to be mounted together

SHOWN:

RGC-20-T-2.0 with RGC-20-2.0

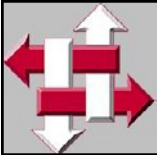

PRODUCT FEATURES

- Aircraft Grade Aluminum
Black Anodize Finish
- Simple and Highly Durable
Time tested, field approved design

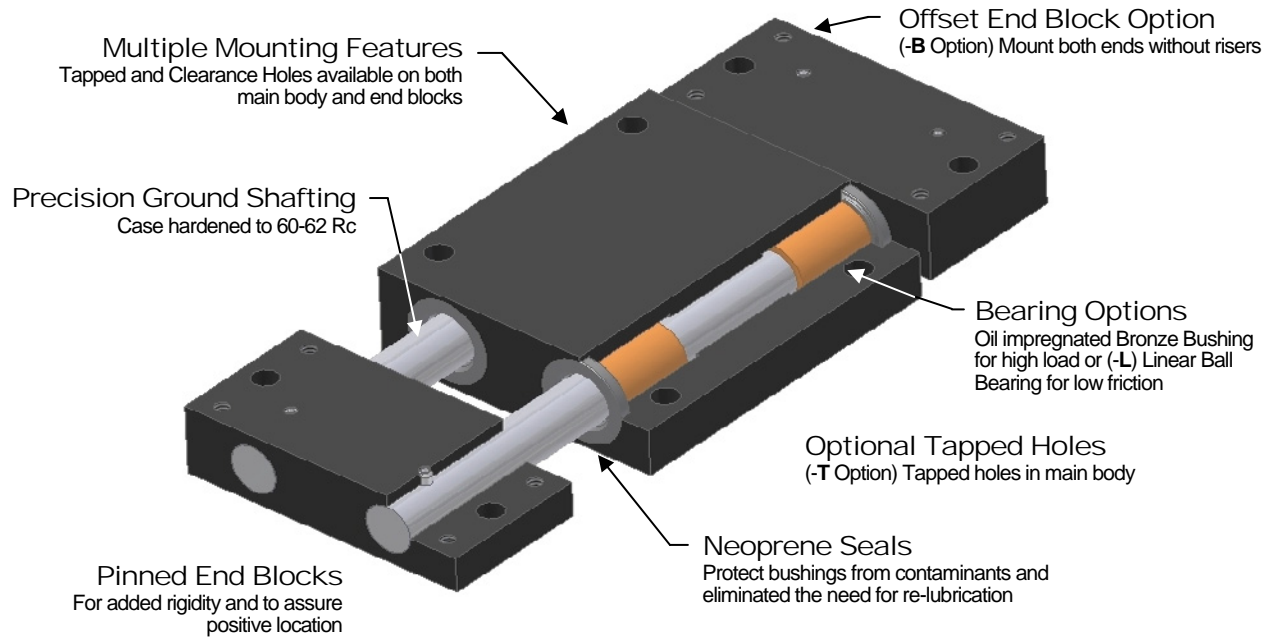

DESIGNED - MANUFACTURED - ASSEMBLED IN THE USA

MOUNTING INFORMATION

Mounts and operates in any orientation

CENTER MOUNT (Cantilever slide)

- Payload on End Blocks

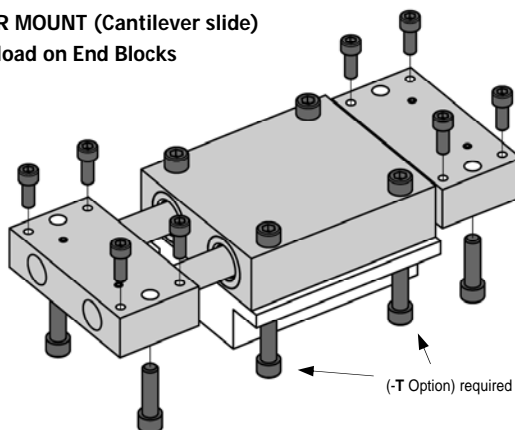

CENTER MOUNT thru Main body using Clearance holes or up to Main body using optional Tapped holes (-T)

PAYLOAD can mount to End blocks utilizing either Clearance holes or Tapped holes

END MOUNT (Gantry / Base slide)

- Payload on Main Body

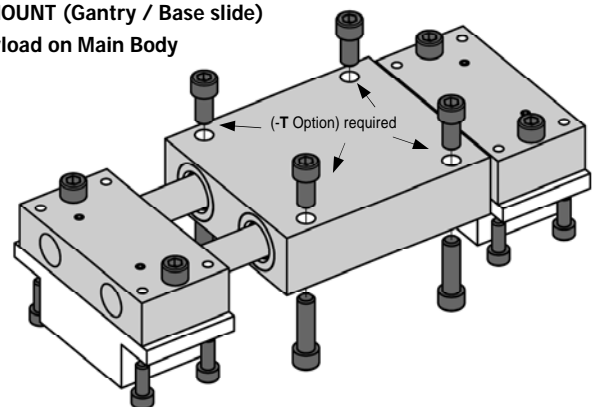

END MOUNT thru End blocks using Clearance holes or up to End Blocks using Tapped holes

PAYLOAD can mount to Main body utilizing either Clearance holes or optional Tapped holes (-T)



DIMENSIONAL DRAWING

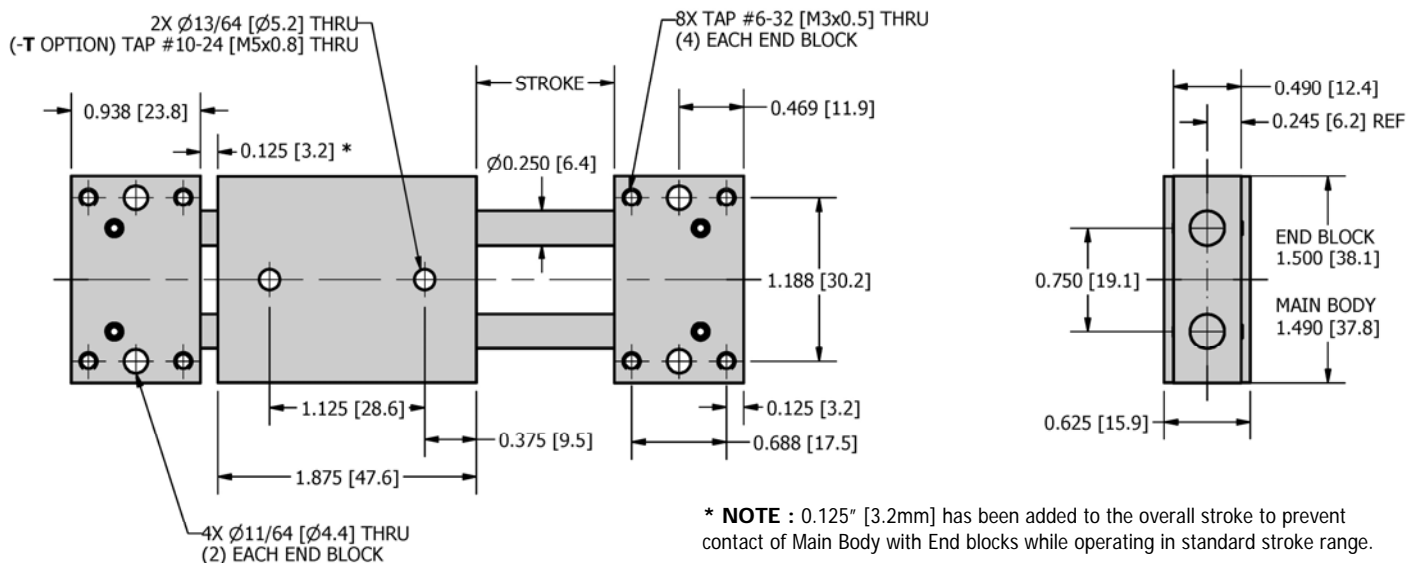

LOADING	RGC-5	MRGC-5
Max Dynamic Moment M	15 lbf-in	1.7 N-m
Max Dynamic Force F	SEE BELOW	

SPECIFICATIONS	RGC-5	MRGC-5
Maximum Stroke	3.000"	76.2 mm
Base Weight (no stroke)	0.37 lbs	0.17 kg
Additional weight per Stroke	0.014 lbs/in	0.251g/mm

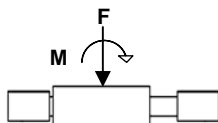
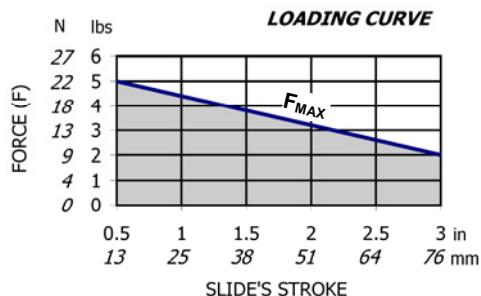

OFFSET END BLOCK OPTION (-B)

Permits mounting both end blocks to a plane surface without risers. All dimensions are the same as standard model except as shown below

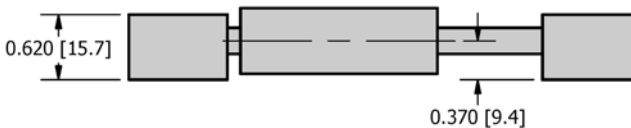

These are suggested Dynamic loads for smooth operation and normal life expectancy. Higher Static loads are possible, consult with factory.

HOW TO ORDER : BASIC UNIT

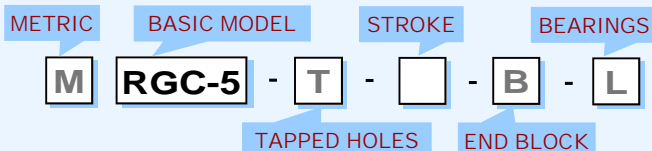

SAMPLE ORDER: RGC-5-T-0.25

Ex) RGC-5 with tapped holes and 0.25" stroke

- METRIC** M
- HOLES** T - Tapped Holes in Main Body
- STROKE** Inch: 0.25" - 3.00" @ 0.25" Increments
mm: 6.35mm - 76.20mm @ 6.35 mm Increments
- END BLOCK** B - Offset End Blocks
- BEARINGS** L - Linear Ball Bearings (Bushings standard)

CUSTOM DESIGNS INCLUDING

- LONGER STROKES
- MULTIPLE STATION DESIGNS

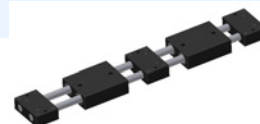

ALWAYS AVAILABLE PLEASE CONTACT US FOR INFORMATION



DIMENSIONAL DRAWING

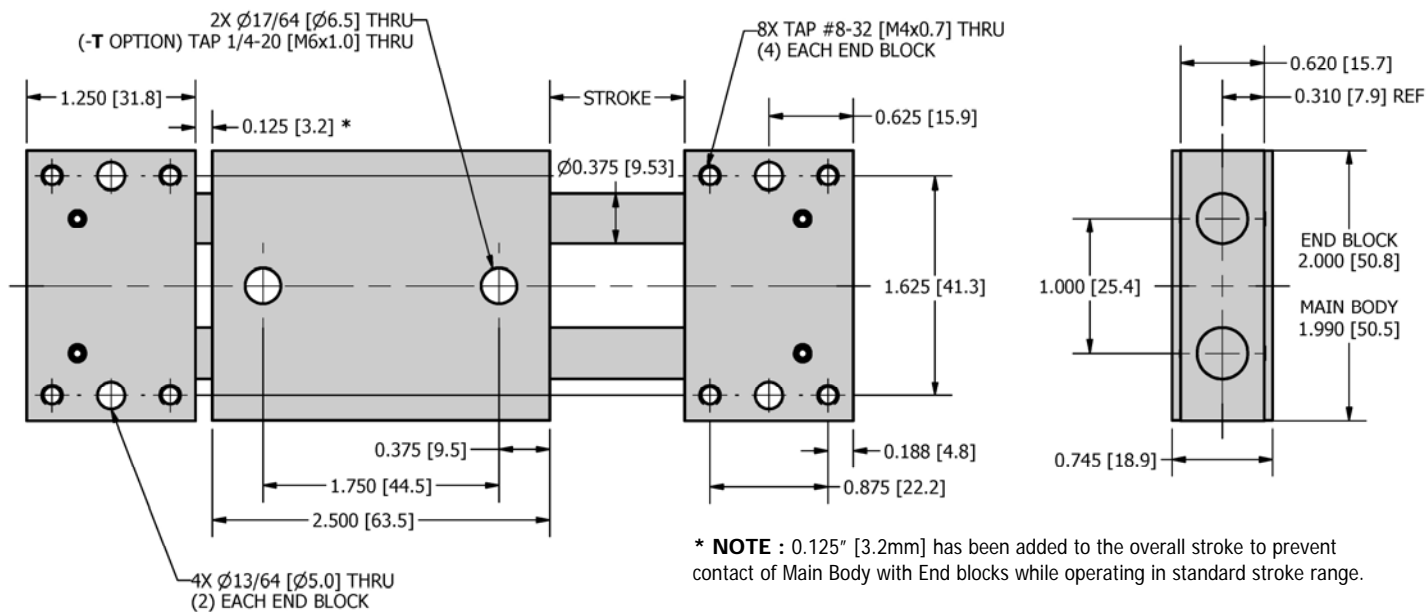

* **NOTE** : 0.125" [3.2mm] has been added to the overall stroke to prevent contact of Main Body with End blocks while operating in standard stroke range.

LOADING	RGC-10	MRGC-10
Max Dynamic Moment M	75 lbf-in	8.4 N-m
Max Dynamic Force F	SEE BELOW	

SPECIFICATIONS	RGC-10	MRGC-10
Maximum Stroke	4.000"	101.6 mm
Base Weight (no stroke)	0.78 lbs	0.36 kg
Additional weight per Stroke	0.031 lbs/in	0.556 g/mm

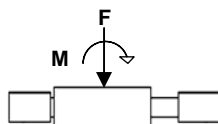
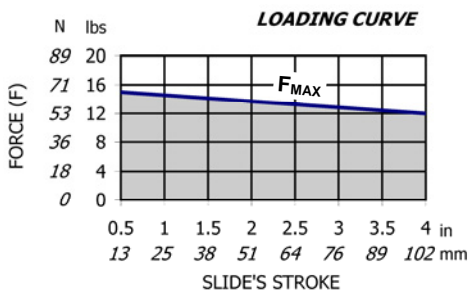

These are suggested Dynamic loads for smooth operation and normal life expectancy. Higher Static loads are possible, consult with factory.

OFFSET END BLOCK OPTION (-B)

Permits mounting both end blocks to a plane surface without risers. All dimensions are the same as standard model except as shown below

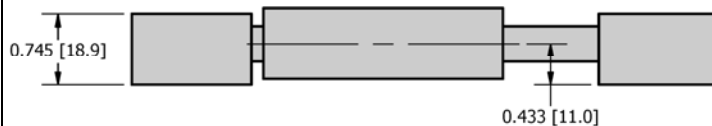

HOW TO ORDER : BASIC UNIT

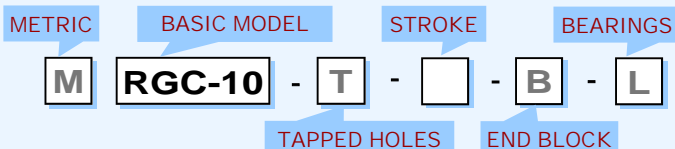

- METRIC** M
- HOLES** T - Tapped Holes in Main Body
- STROKE** Inch: 0.5" - 4.0" @ 0.5" Increments
mm: 12.7mm - 101.6mm @ 12.7mm Increments
- END BLOCK** B - Offset End Blocks
- BEARINGS** L - Linear Ball Bearings (Bushings standard)

SAMPLE ORDER: RGC-10-1.0

Ex) RGC-10 with 1.0" stroke

CUSTOM DESIGNS INCLUDING

- LONGER STROKES
- MULTIPLE STATION DESIGNS

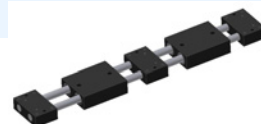

ALWAYS AVAILABLE PLEASE CONTACT US FOR INFORMATION

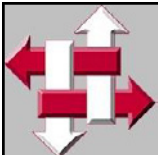

DIMENSIONAL DRAWING

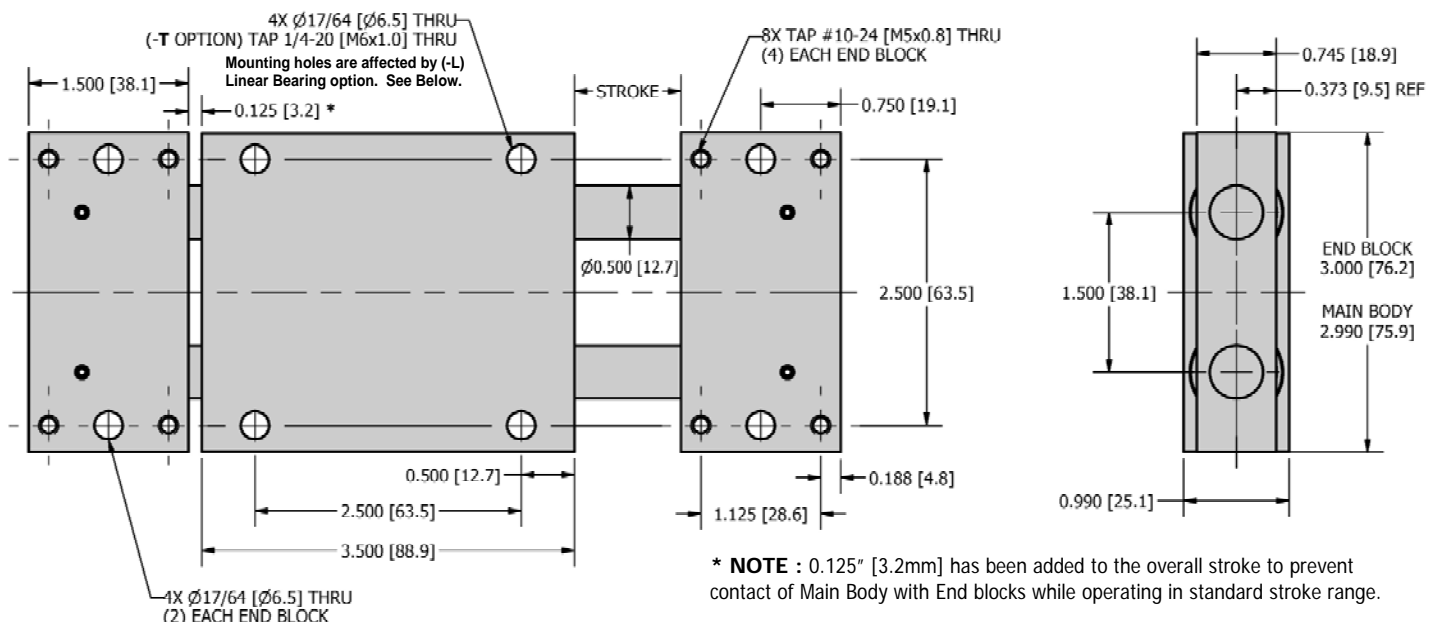

LOADING	RGC-20	MRGC-20
Max Dynamic Moment M	150 lbf-in	16.9 N-m
Max Dynamic Force F	SEE BELOW	

SPECIFICATIONS	RGC-20	MRGC-20
Maximum Stroke	6.000"	152.4 mm
Base Weight (no stroke)	2.02 lbs	0.91 kg
Additional weight per Stroke	0.055 lbs/in	0.989 g/mm

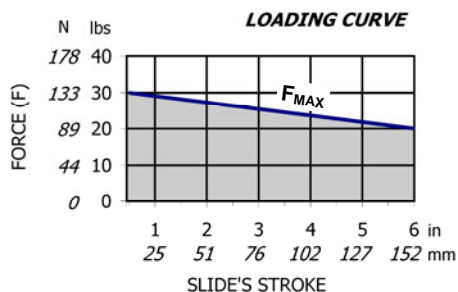

These are suggested Dynamic loads for smooth operation and normal life expectancy. Higher Static loads are possible, consult with factory.

OFFSET END BLOCK OPTION (-B)

Permits mounting both end blocks to a plane surface without risers. All dimensions are the same as standard model except as shown below

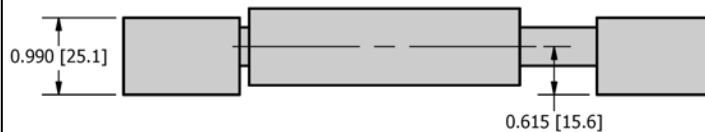

HOW TO ORDER : BASIC UNIT

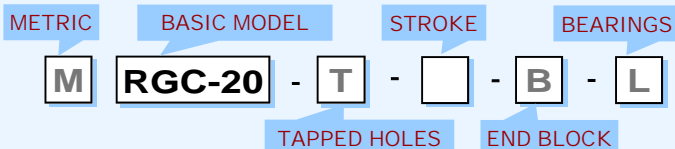

- METRIC** M
- HOLES** T - Tapped Holes in Main Body
- STROKE** Inch: 0.5" - 6.0" @ 0.5" Increments
mm: 12.7mm - 152.4mm @ 12.7mm Increments
- END BLOCK** B - Offset End Blocks
- BEARINGS** L - Linear Ball Bearings * (Bushings standard)

* Affects mounting holes on Main Body, must order with (-T) Tapped Holes option. Tapped Holes will have thread depth of 0.25 [6.4] both sides.

SAMPLE ORDER: RGC-20-2.0-B

Ex) RGC-20 with 2.00" stroke and offset end blocks

CUSTOM DESIGNS INCLUDING

- LONGER STROKES
- MULTIPLE STATION DESIGNS

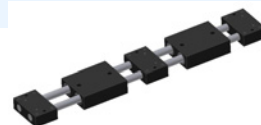

ALWAYS AVAILABLE PLEASE CONTACT US FOR INFORMATION



R&I
MANUFACTURING CO.

DURA-SLIDE
NON-POWERED

RGC-30

DIMENSIONAL DRAWING

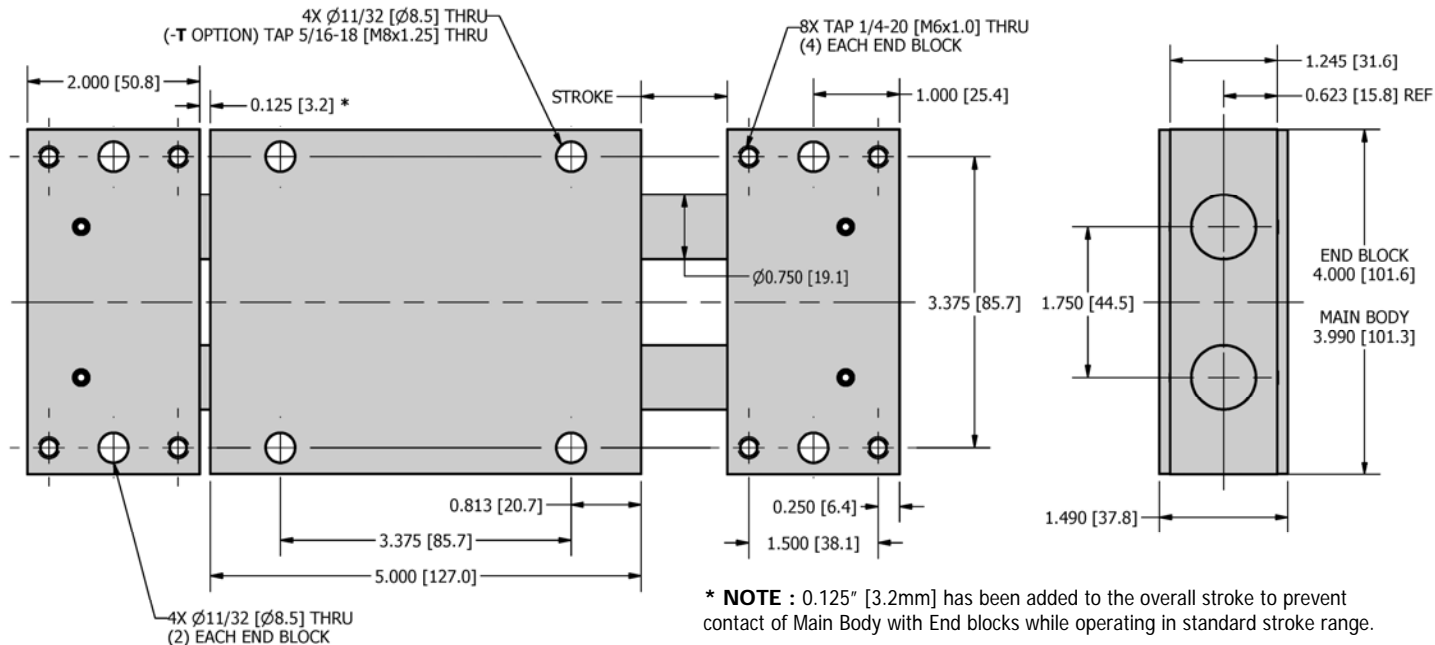

LOADING	RGC-30	MRGC-30
Max Dynamic Moment M	600 lbf-in	67.7 N-m
Max Dynamic Force F	SEE BELOW	

SPECIFICATIONS	RGC-30	MRGC-30
Maximum Stroke	8.000"	203.2 mm
Base Weight (no stroke)	5.63 lbs	2.55 kg
Additional weight per Stroke	0.125 lbs/in	2.235 g/mm

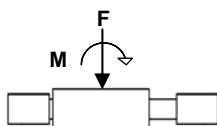
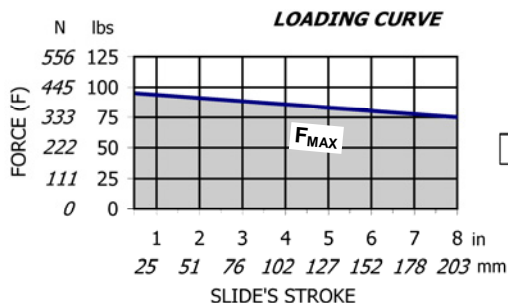

OFFSET END BLOCK OPTION (-B)

Permits mounting both end blocks to a plane surface without risers. All dimensions are the same as standard model except as shown below

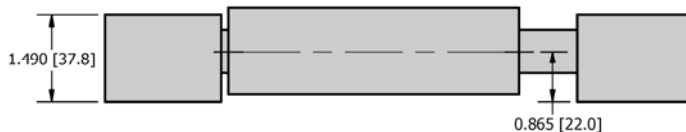

These are suggested Dynamic loads for smooth operation and normal life expectancy. Higher Static loads are possible, consult with factory.

HOW TO ORDER : BASIC UNIT

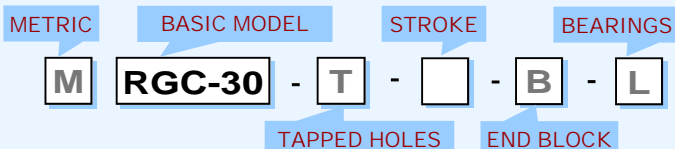

- METRIC M
- HOLES T - Tapped Holes in Main Body
- STROKE Inch: 0.5" - 8.0" @ 0.5" Increments
mm: 12.7mm - 203.2 @ 12.7mm Increments
- END BLOCK B - Offset End Blocks
- BEARINGS L - Linear Ball Bearings (Bushings standard)

SAMPLE ORDER: RGC-30-T-2.0

Ex) RGC-30 with tapped holes and 2.0" stroke

CUSTOM DESIGNS INCLUDING

- LONGER STROKES
- MULTIPLE STATION DESIGNS

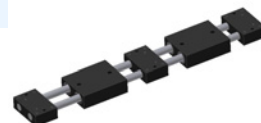

ALWAYS AVAILABLE PLEASE CONTACT US FOR INFORMATION



DIMENSIONAL DRAWING

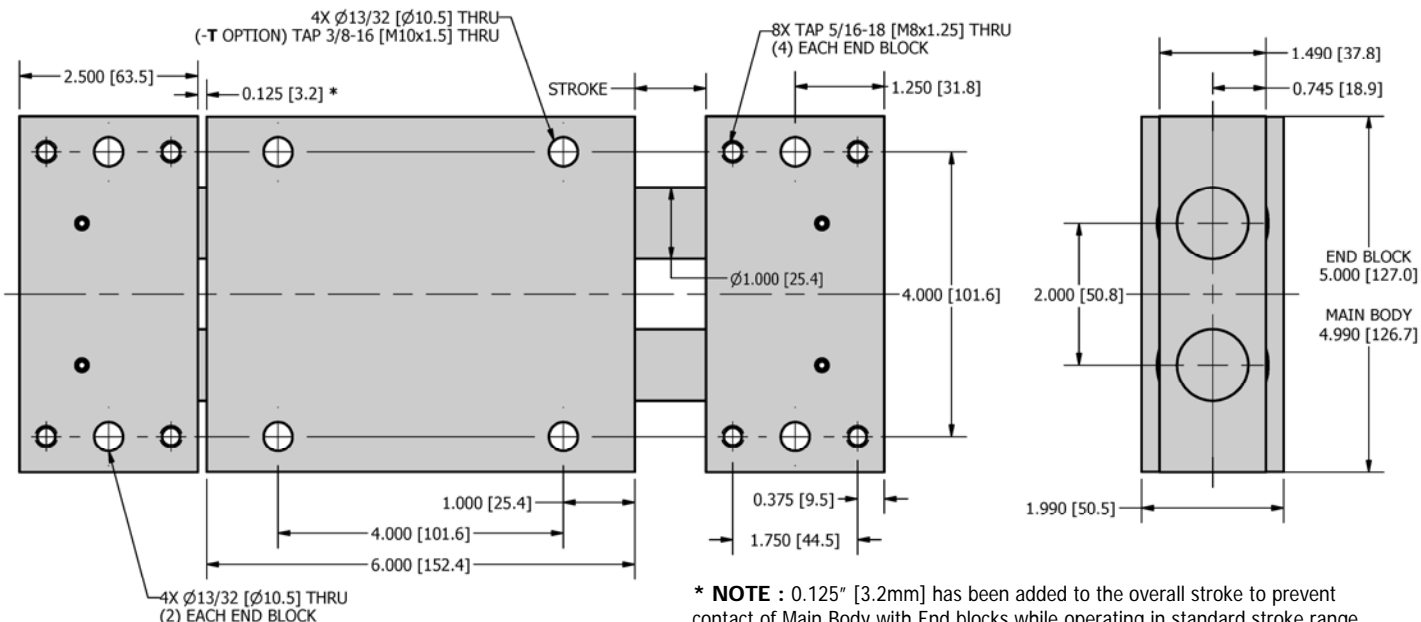

LOADING	RGC-40	MRGC-40
Max Dynamic Moment M	1200 lbf-in	135 N-m
Max Dynamic Force F	SEE BELOW	

SPECIFICATIONS	RGC-40	MRGC-40
Maximum Stroke	10.000"	254.0 mm
Base Weight	11.49 lbs	5.21 kg
Additional weight per Stroke	0.224 lbs/in	4.003 g/mm

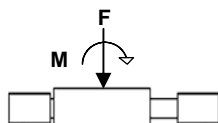
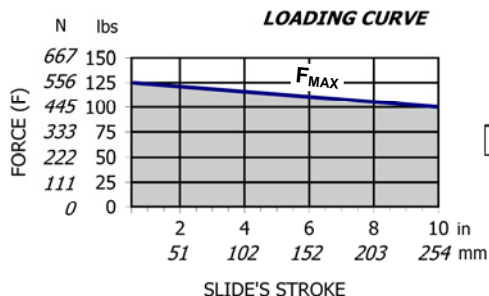

OFFSET END BLOCK OPTION (-B)

Permits mounting both end blocks to a plane surface without risers. All dimensions are the same as standard model except as shown below

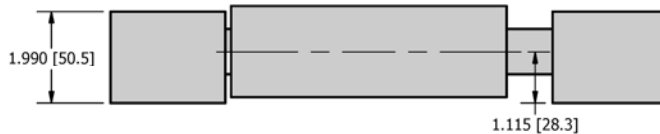

These are suggested Dynamic loads for smooth operation and normal life expectancy. Higher Static loads are possible, consult with factory.

HOW TO ORDER : BASIC UNIT

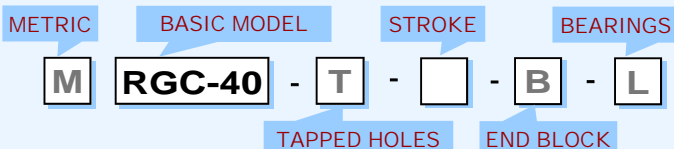

- METRIC** M
- HOLES** T - Tapped Holes in Main Body
- STROKE** Inch: 0.5" - 10.0" @ 0.5" Increments
mm: 12.7mm - 254mm @ 12.7mm Increments
- END BLOCK** B - Offset End Blocks
- BEARINGS** L - Linear Ball Bearings (Bushings standard)

SAMPLE ORDER: RGC-40-0.5

Ex) RGC-40 with 0.5" stroke

CUSTOM DESIGNS INCLUDING

- LONGER STROKES
- MULTIPLE STATION DESIGNS

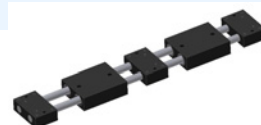

ALWAYS AVAILABLE PLEASE CONTACT US FOR INFORMATION



R&I
MANUFACTURING CO.

DURA-SLIDE
NON-POWERED

RGC-SERIES

EXPLODED VIEW

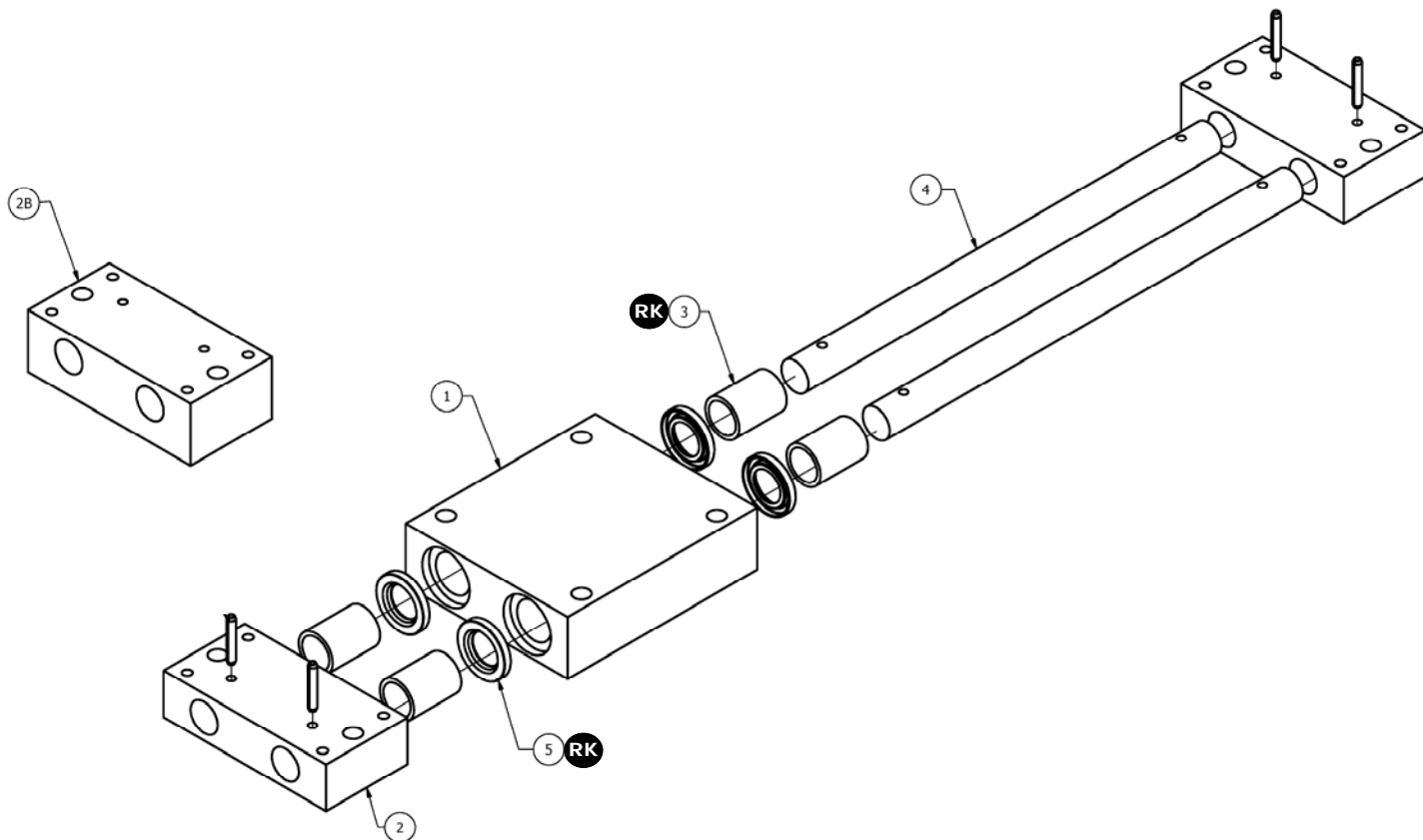

PARTS LIST

HOW TO ORDER PARTS

ITEM	REQ'D	NAME	RGC-5	RGC-10	RGC-20	RGC-30	RGC-40	OPTIONS
1	1	Main Body	RGC-051	RGC-101	RGC-201	RGC-301	RGC-401	-T ¹ -L ⁴
2	2	End Block	RGC-052	RGC-102	RGC-202	RGC-302	RGC-402	-B ³
3	4	Bearings *	RGC-053	RGC-103	RGC-203	RGC-303	RGC-403	-L ⁴
4	2	Rod	RGC-054	RGC-104	RGC-204	RGC-304	RGC-404	-S ²
5	4	Shaft Seal *	SSA-210	SSA-215	SSA-225	SSA-245	SSA-360	
RK	1	Repair Kit **	RGC-5-RK	RGC-10-RK	RGC-20-RK	RGC-30-RK	RGC-40-RK	-L ⁴

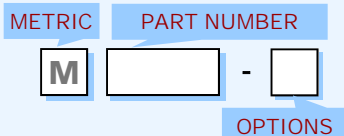

SAMPLE ORDER: RGC-101-T-L

Ex) RGC-10 Main Body with Tapped holes and Linear Ball Bearing ready

OPTIONS (see product pages for information)

- 1 - T = Tapped Holes
- 2 - S = Stroke
- 3 - B = Offset End Block
- 4 - L = Linear Ball Bearings

NOTES

- * - Metric code not required
- # - Repair Kits include req'd qty of parts marked with RK