

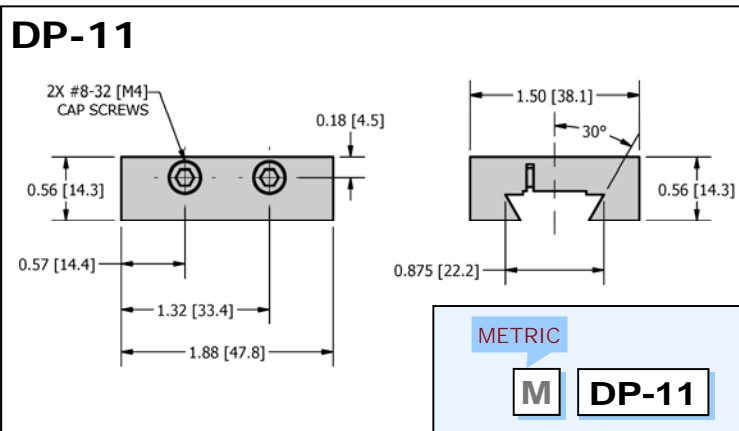

DP-SERIES - UNIVERSAL DOVETAIL PLATES



WORKS WITH

ANGULAR

PARALLEL

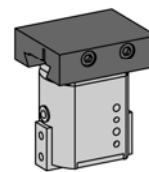
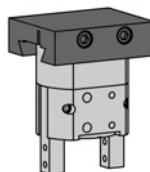

MH-21A/22A

PH-40

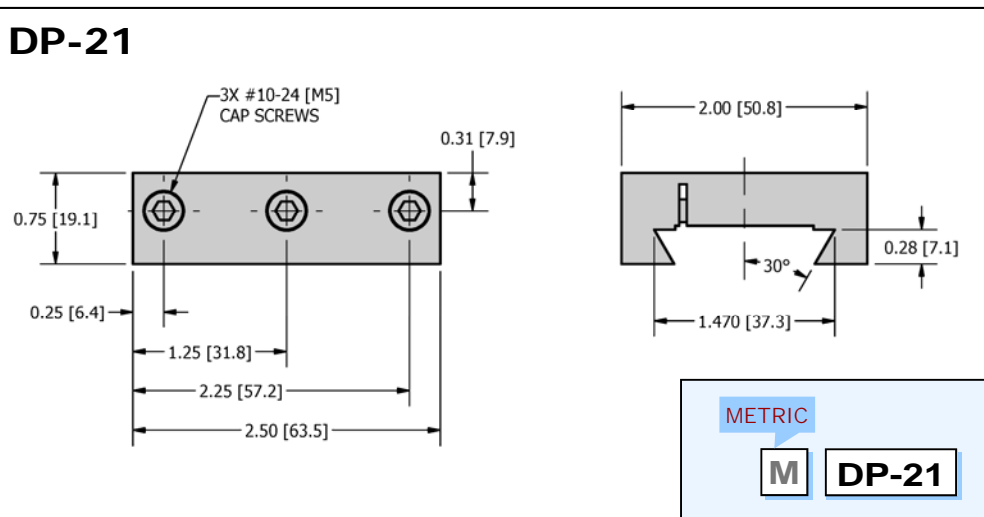

WORKS WITH

ANGULAR

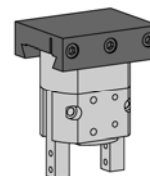

GH-21A/22A
GH-21B/22B
GH-201A/202A
GH-31A
GH-301A
RB-94

PARALLEL

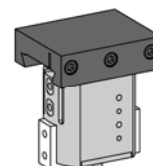

PH-20
PH-30
PH-50/60
PH-70

MD-JG - ADAPTER PLATE

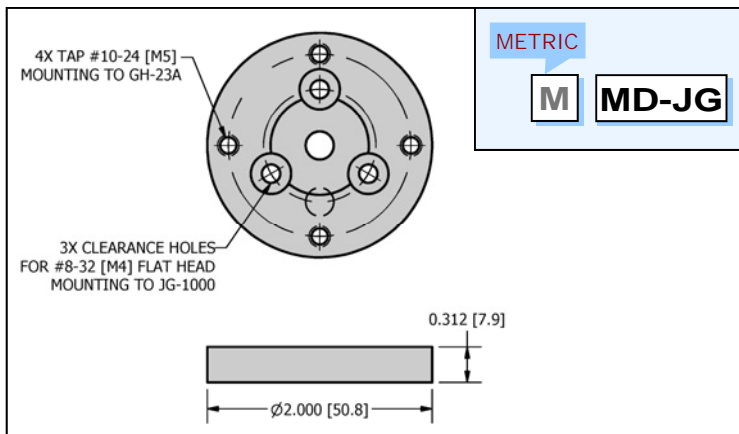

WORKS WITH

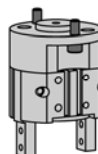

GH-23A/B
TO
JG-1000

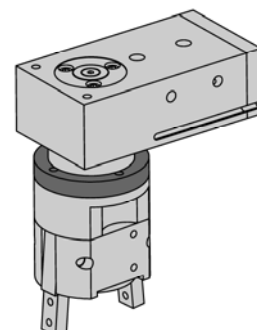
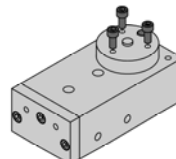

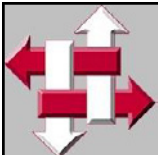

NB-1A - ADJUSTABLE DOVETAIL BRACKET

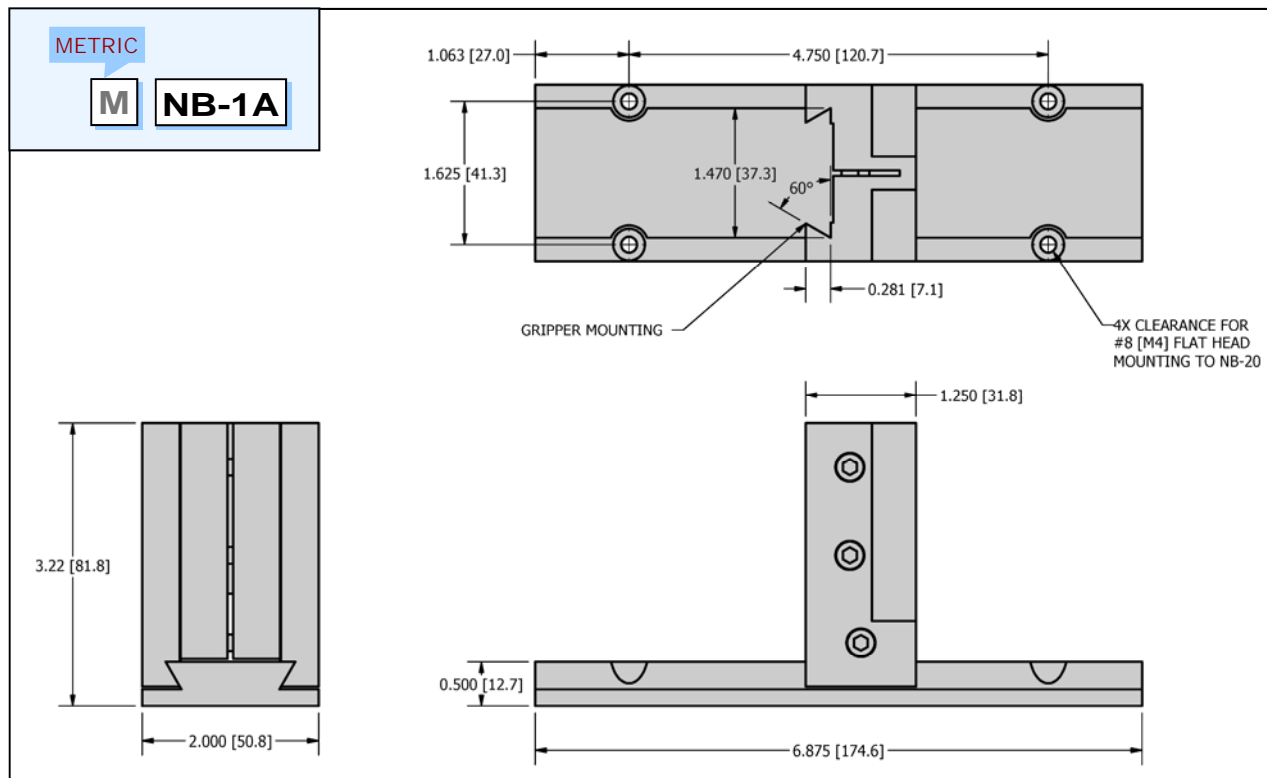

Use the **NB-1A** adjustable tooling to mount the following **DURA-GRIP** grippers to **NB-20**

WORKS WITH

ANGULAR

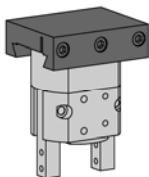

- GH-21A/22A
- GH-21B/22B
- GH-201A/202A
- GH-31A
- GH-301A
- RB-94

PARALLEL

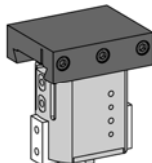

- PH-20
- PH-30
- PH-50/60
- PH-70

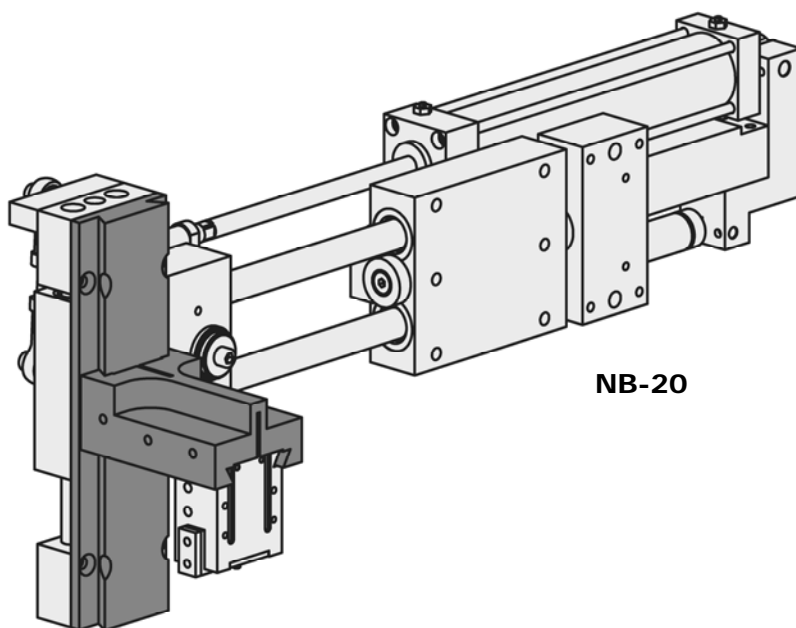

NB-20

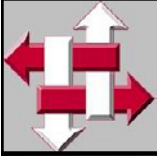

ADP-SERIES - 2-WAY ADJUSTABLE DOVETAIL BRACKET

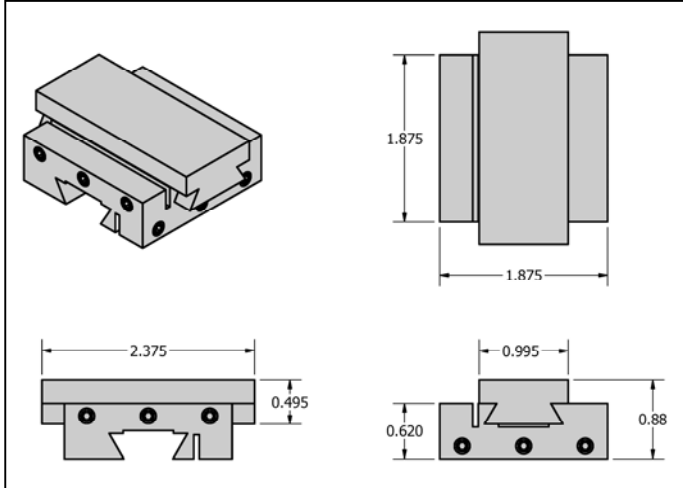

Use the **ADP** SERIES to build in 2-way adjustment when mounting the following **DURA-GRIP** grippers. Match the female dovetail to the appropriate gripper and modify the male dovetail blank to mount to your application or let us know and we'll modify for you.

WORKS WITH - SMALL DOVETAIL TOP CAPS

<i>ANGULAR</i>	<i>PARALLEL</i>
MH-21A/22A	PH-40

METRIC

M ADP-11

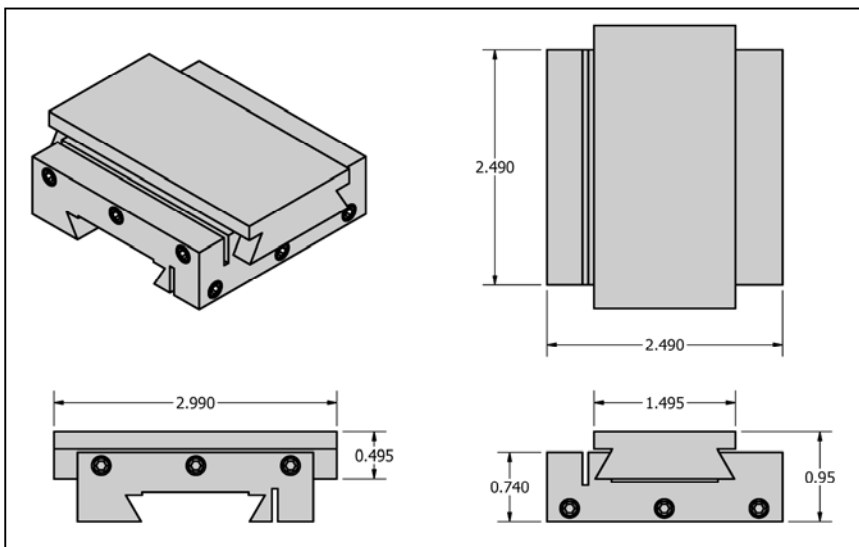

WORKS WITH - LARGE DOVETAIL TOP CAPS

<i>ANGULAR</i>	<i>PARALLEL</i>
GH-21A/22A	PH-20
GH-21B/22B	PH-30
GH-201A/202A	PH-50/60
GH-31A	PH-70
GH-301A	
RB-94	

METRIC

M ADP-21

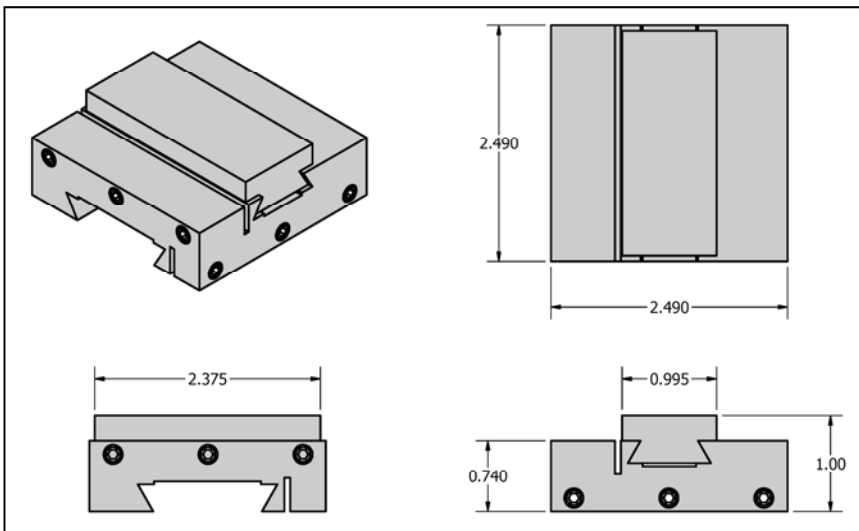

WORKS WITH - LARGE DOVETAIL TOP CAPS BUT USES SMALL MALE DOVETAIL BRACKET

<i>ANGULAR</i>	<i>PARALLEL</i>
GH-21A/22A	PH-20
GH-21B/22B	PH-30
GH-201A/202A	PH-50/60
GH-31A	PH-70
GH-301A	
RB-94	

METRIC

M ADP-22



BB-4 - BREAKAWAY MOUNTING BRACKET

Use the **BB-4** for a low-cost breakaway device for **DURA-GRIP** grippers

Adjustable Hard Stops

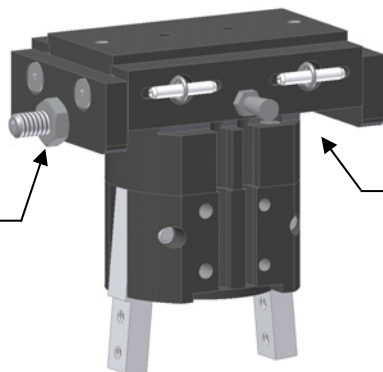

Spring Loaded Dovetail

WORKS WITH

PARALLEL

- PH-20
- PH-30
- PH-50/60
- PH-70

ANGULAR

- GH-21A/22A
- GH-21B/22B
- GH-201A/202A
- GH-31A
- GH-301A
- RB-94

METRIC

M

BB-4

NOTES:

- 1) It is recommended that the gripper be tethered to your prime mover. This will prevent the gripper from falling if breakaway occurs. A safety switch should also be used to signal that the head has broken away.
- 2) A key way slot is required in the DURA-GRIP top cap. Use the diagram below for all gripper models.

DURA-GRIP TOP CAP MATING SURFACE

REQUIRED TOP CAP MODIFICATIONS

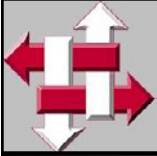

R&I
MANUFACTURING CO.

TECH NOTES